



Structural Engineering Services

Our team of Structural Engineers and CAD experts take great pride in designing the **most cost-effective solutions** using the **very latest design codes**.



Experienced and enthusiastic team who give the same focus and attention to detail to every client, from private landowners through to major site developers.



Specific expertise in the design of retaining walls, wing walls, wet wells, hydraulic chambers, base slabs and cover slabs. We also undertake structural surveys, assessments, condition and dilapidation reports.



The team is led by **Dr Mohamed Diriye**, a Chartered Structural Engineer with **25 years of experience** in the UK and internationally. He has worked in all sectors on an extensive range of projects including residential developments, commercial construction projects, and sports and leisure stadia.



Our Structural Team are supported by **in-house Geotechnical Engineers, Geologists, and Site Inspectors**. Their understanding of ground conditions reduces the risk for clients and means that we can react quickly to unforeseen construction issues.

We understand land

GRM are proud of our reputation for providing a wide range of structural engineering services and solutions to landowners and developers across the UK.

Each project is given the same focus and attention to detail. Our aim is to provide the very best solutions and designs at the most cost-effective price. This is reflected in the fact that over 80% of our structural engineering work comes from repeat business or recommendations from existing clients.

We have built up a team that has decades of experience and an extensive skill set. Speciality services include the design of retaining walls and drainage components such as hydro-brake chambers, in-situ weir walls and wet wells along with base slabs and cover slabs. All of which can be designed to various heights and sizes to suit your bespoke requirements. We also undertake structural surveys, assessments, and various condition reports.

Our Structural Engineers and Design Team are supported by in-house Geotechnical Engineers, Geologists, and Site Inspectors. Having such a diverse skill set under one roof ensures that our designs are compatible with the clients proposed development scheme.

Coupled with our end-to-end service including land appraisal and ground investigation means larger projects can all be managed under one roof, which saves time, cost and confusion.

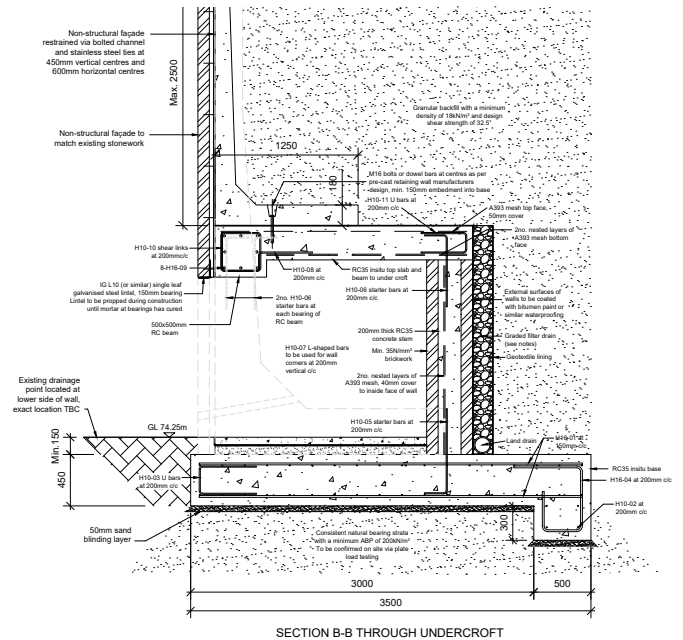

To find out more or have a discussion about your structural engineering requirements then please contact mohamed.diriye@grm-uk.com or call 01283 551249

Land Appraisal | Environmental | Geotechnical | Design | Mining | Inspections

Please contact us for an informal discussion on how we can save both time and money on your development project:

www.grm-uk.com | 01283 551249 | info@grm-uk.com

